

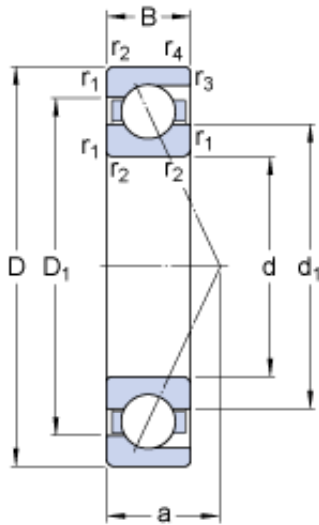

# NTN-SNR BEARING RULMENTI S.R.L.



600 mm x 800 mm x 90 mm skf 719/600 ACM  
Single row angular contact ball bearings

Bearing No. 719/600 ACM

719/600 ACM Bearing 2D drawings and 3D CAD models

Size	800x600x90 mm
Bore Diameter	800 mm
Outer Diameter	600 mm
Width	90 mm
d	600 mm
D	800 mm
B	90 mm
d <sub>1</sub>	666 mm
D <sub>1</sub>	737 mm
a	208 mm
r <sub>1,2</sub> - min.	5 mm
r <sub>3,4</sub> - min.	2 mm
d <sub>a</sub> - min.	618 mm
D <sub>a</sub> - max.	782 mm
D <sub>b</sub> - max.	791 mm
r <sub>a</sub> - max.	4 mm
r <sub>b</sub> - max.	2 mm
Basic dynamic load rating - C	715 kN
Basic static load rating - C <sub>0</sub>	1730 kN
Fatigue load limit - P <sub>u</sub>	27.5 kN
Reference speed	750 r/min
Limiting speed	800 r/min
Calculation factor - k <sub>r</sub>	0.083
Calculation factor - k <sub>a</sub>	0.25



## NTN-SNR BEARING RULMENTI S.R.L.

Calculation factor - e	0.68
Calculation factor - X	0.41
Calculation factor - $Y_0$	0.38
Calculation factor - $Y_1$	
Calculation factor - $Y_2$	0.87
$d_1$	666 mm
$D_1$	737 mm
$r_{1,2}$ min.	5 mm
$r_{3,4}$ min.	2 mm
$d_a$ min.	618 mm
$D_a$ max.	782 mm
$D_b$ max.	791 mm
$r_a$ max.	4 mm
$r_b$ max.	2 mm
Basic dynamic load rating C	715 kN
Basic static load rating $C_0$	1730 kN
Fatigue load limit $P_u$	27.5 kN
Calculation factor A	14.6
Calculation factor $k_r$	0.083
Calculation factor e	0.68
Calculation factor X	0.41
Calculation factor $Y_0$	0.38
Calculation factor $Y_2$	0.87
Mass bearing	125 kg