

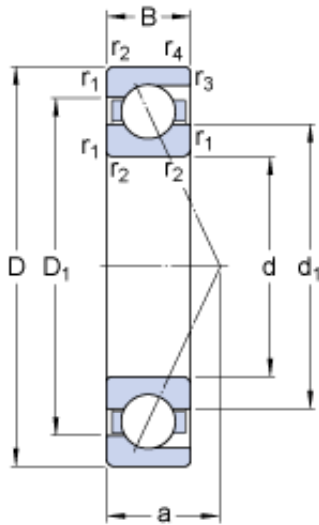

NTN-SNR BEARING RULMENTI S.R.L.



560 mm x 750 mm x 85 mm skf 719/560 AMB
Single row angular contact ball bearings

Bearing No. 719/560 AMB

719/560 AMB Bearing 2D drawings and 3D CAD models

Size	750x560x85 mm
Bore Diameter	750 mm
Outer Diameter	560 mm
Width	85 mm
d	560 mm
D	750 mm
B	85 mm
d ₁	622.6 mm
D ₁	690.6 mm
a	232 mm
r _{1,2} - min.	5 mm
r _{3,4} - min.	2 mm
d _a - min.	578 mm
D _a - max.	732 mm
D _b - max.	741 mm
r _a - max.	4 mm
r _b - max.	2 mm
Basic dynamic load rating - C	592 kN
Basic static load rating - C ₀	1290 kN
Fatigue load limit - P _u	22.8 kN
Reference speed	800 r/min
Limiting speed	850 r/min
Calculation factor - k _r	0.083
Calculation factor - k _a	0.4



NTN-SNR BEARING RULMENTI S.R.L.

Calculation factor - e	0.8
Calculation factor - X	0.63
Calculation factor - Y_0	0.66
Calculation factor - Y_1	0.78
Calculation factor - Y_2	1.24
Calculation factor - X	0.39
Calculation factor - Y_0	0.33
Calculation factor - Y_1	
Calculation factor - Y_2	0.76
d_1	622.6 mm
D_1	690.6 mm
$r_{1,2}$ min.	5 mm
$r_{3,4}$ min.	2 mm
d_a min.	578 mm
D_a max.	732 mm
D_b max.	741 mm
r_a max.	4 mm
r_b max.	2 mm
Basic dynamic load rating C	592 kN
Basic static load rating C_0	1290 kN
Fatigue load limit P_u	22.8 kN
Calculation factor A	14.2
Calculation factor k_r	0.083
Calculation factor e	0.8
Calculation factor X	0.39
Calculation factor Y_0	0.33
Calculation factor Y_2	0.76
Calculation factor X	0.63
Calculation factor Y_0	0.66
Calculation factor Y_1	0.78
Calculation factor Y_2	1.24



NTN-SNR BEARING RULMENTI S.R.L.

Mass bearing	
--------------	--

	105 kg
--	--------