

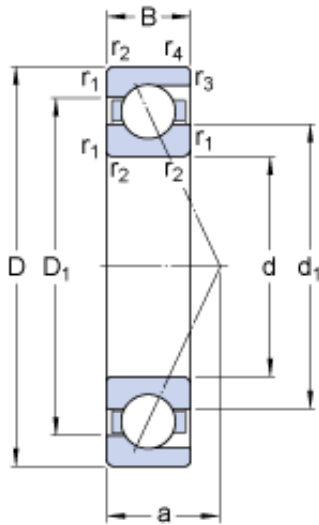

# NTN-SNR BEARING RULMENTI S.R.L.



7418 CBM Bearing 2D drawings and 3D CAD models

90 mm x 225 mm x 54 mm skf 7418 CBM Single row angular contact ball bearings

Bearing No. 7418 CBM

Size	225x90x54 mm
Bore Diameter	225 mm
Outer Diameter	90 mm
Width	54 mm
d	90 mm
D	225 mm
B	54 mm
d <sub>1</sub>	132 mm
D <sub>1</sub>	182.1 mm
a	95 mm
r <sub>1,2</sub> - min.	4 mm
r <sub>3,4</sub> - min.	4 mm
d <sub>a</sub> - min.	55 mm
D <sub>a</sub> - max.	110 mm
D <sub>b</sub> - max.	202 mm
r <sub>a</sub> - max.	2 mm
r <sub>b</sub> - max.	2 mm
Basic dynamic load rating - C	212 kN
Basic static load rating - C <sub>0</sub>	193 kN
Fatigue load limit - P <sub>u</sub>	6.6 kN
Reference speed	3600 r/min
Limiting speed	3800 r/min
Calculation factor - k <sub>r</sub>	0.1
Calculation factor - k <sub>a</sub>	1.6



## NTN-SNR BEARING RULMENTI S.R.L.

Calculation factor - e	1.14
Calculation factor - X	0.57
Calculation factor - Y <sub>0</sub>	0.52
Calculation factor - Y <sub>1</sub>	0.55
Calculation factor - Y <sub>2</sub>	0.93
Calculation factor - X	0.35
Calculation factor - Y <sub>0</sub>	0.26
Calculation factor - Y <sub>1</sub>	
Calculation factor - Y <sub>2</sub>	0.57
Category	Angular Contact Ball Bearings
Inventory	0.0
Manufacturer Name	SKF
Minimum Buy Quantity	N/A
Weight / Kilogram	11.13
Product Group	B00308
Enclosure	Open
Flush Ground	Yes
Rolling Element	Ball Bearing
Number of Rows of Balls	Single Row
Precision Class	ABEC 3   ISO P6
Maximum Capacity / Filling Slot	No
Snap Ring	No
Cage Material	Brass
Contact Angle	40 Degree
Internal Clearance	CB
Number of Bearings	1 (Single)
Mounting Arrangement	Universal
Inch - Metric	Metric
Long Description	90MM Bore; 225MM Outside Diameter; 54MM



## NTN-SNR BEARING RULMENTI S.R.L.

	Width; Open; Yes Flush Ground; Ball Bearing; Single Row of Balls; ABEC 3   ISO P6; No Filling Slot; No Snap Ring
Other Features	Normal Axial Internal Clearance
Category	Angular Contact Ball Bearing
UNSPSC	31171531
Harmonized Tariff Code	8482.10.50.28
Noun	Bearing
Keyword String	Angular Contact
Manufacturer URL	<a href="http://www.skf.com">http://www.skf.com</a>
Manufacturer Item Number	7418 CBM
Weight / LBS	24.519
Width	2.126 Inch   54 Millimeter
Bore	3.543 Inch   90 Millimeter
Outside Diameter	8.858 Inch   225 Millimeter
bore diameter:	90 mm
radial static load capacity:	200 kN
outside diameter:	225 mm
cage material:	Brass
overall width:	54 mm
outer ring width:	54 mm
contact angle:	40 °
maximum rpm:	3800 RPM
row type & fill slot:	Single-Row Non-Fill Slot
finish/coating:	Uncoated
internal clearance:	C0
precision rating:	ABEC 3 (ISO Class 6)
closure type:	Open
fillet radius:	3 mm
radial dynamic load	216 kN



## NTN-SNR BEARING RULMENTI S.R.L.

capacity:	
series:	74
$d_1$	132 mm
$D_1$	182.1 mm
$r_{1,2}$ min.	4 mm
$r_{3,4}$ min.	4 mm
$d_a$ min.	55 mm
$D_a$ max.	110 mm
$D_b$ max.	202 mm
$r_a$ max.	2 mm
$r_b$ max.	2 mm
Basic dynamic load rating C	212 kN
Basic static load rating $C_0$	193 kN
Fatigue load limit $P_u$	6.55 kN
Calculation factor A	0.725
Calculation factor $k_r$	0.1
Calculation factor e	1.14
Calculation factor X	0.35
Calculation factor $Y_0$	0.26
Calculation factor $Y_2$	0.57
Calculation factor X	0.57
Calculation factor $Y_0$	0.52
Calculation factor $Y_1$	0.55
Calculation factor $Y_2$	0.93
Mass bearing	11.5 kg